

- OVERHEAD SERVICE DROP CLEARANCES**
- Service drop conductors are protected by isolation; they typically have no protective outer jacket and no overload protection at their source. Utility rules may override the specifications in the code, so check with the AHJ to determine variations from the clearances below. These clearances also apply to overhead feeders.
- Vertical above Roof F1** **17 NEC**
- < 4-in-12 slope: min 8 ft. **A** EXC \_\_\_\_\_ 230.24A
  - 3 ft. OK if roof area guarded or isolated \_\_\_\_\_ 230.24AX5
  - ≥ 4-in-12 slope: min 3 ft. **B** EXC \_\_\_\_\_ 230.24AX2
  - Over eaves 18 in. OK for ≤ 4 ft. horizontal 6 ft. of conductor **C** \_\_\_\_\_ 230.24AX3
  - Maintain req'd distance for 3 ft. past roof edge EXC \_\_\_\_\_ 230.24A
  - Edge clearance above roof is not req'd where overhead conductors attach to side of building \_\_\_\_\_ 230.24AX4
  - Metal support structures for conductors passing over roofs req bonding to neutral of service drop \_\_\_\_\_ 230.29<sup>1</sup>
- Vertical above Grade F1** **17 NEC**
- 10 ft. above final grade to lowest point of drip loop \_\_\_\_\_ 230.24B1
  - Area accessible only to pedestrians: 10 ft. **D** \_\_\_\_\_ 230.24B1
  - General above grade & driveways: 12 ft. **E** \_\_\_\_\_ 230.24B2
  - Above roads or parking areas subject to truck traffic: 18 ft. **F** \_\_\_\_\_ 230.24B4
  - Any direction < 10 ft. horizontal from swimming pool water: 22 1/2 ft. \_\_\_\_\_ 680.8A
- Clearance from Openings & Communication Wires F1** **17 NEC**
- Vertical above decks & balconies: 10 ft. **G** \_\_\_\_\_ 230.9B
  - From side of area above decks & balconies: 3 ft. **H** \_\_\_\_\_ 230.9A
  - Below or to sides of openable window: 3 ft. **I** \_\_\_\_\_ 230.9A
  - Communications wire min 12 in. to parallel power wires \_\_\_\_\_ 800.44A4
  - Communications wires above roofs same as power conductors \_\_\_\_\_ 800.44B
- Window & door clearances apply to open conductors – not to conductors contained inside a raceway or a cable with an overall outer jacket. Clearance req's above a window are typically per the local utility.*

All construction must conform to the current adopted codes with State of Georgia Amendments

- 2018 International Residential Code
- 2018 International Building Code
- 2018 International Energy Efficiency Code
- 2018 International Mechanical Code
- 2018 International Plumbing Code
- 2018 International Swimming Pool and Spa Code
- 2020 National Electrical Code
- 2010 Georgia ADA Code

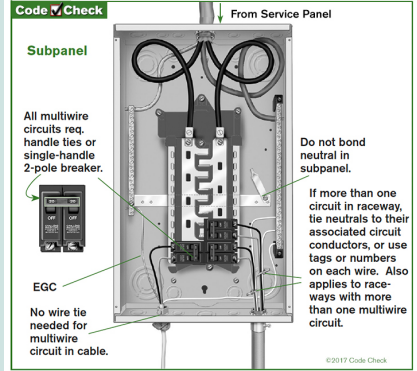
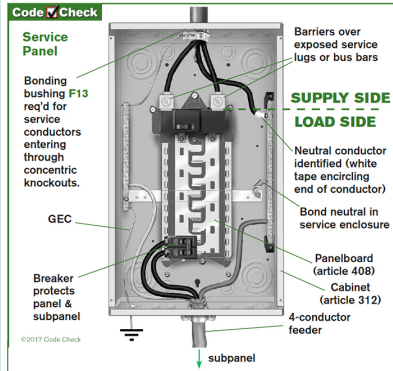
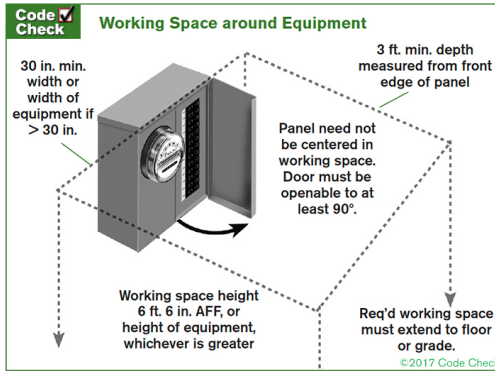

## Inspection Services Department

240 Pine Ave Ste 300  
 Albany, GA 31702  
 Monday through Friday  
 8:00am to 4:30pm  
 inspections@albanyga.gov  
 Inspection Phone 229-302-1855

The information contained within this bulletin is the most common needed to obtain a permit and is not representative of all the conditions that may be encountered during the construction of your project.

